



This guide is for Android 5+ Smartphone users.



AbiBird®

How to

Set up your AbiFit Sensor

Before you can use your AbiFit sensor you need to download and install the STS Secure app, and create an STS Cloud account.

To download the STS Secure app and create an account, you need to:

1. Access STS Secure app from App Store
2. Install STS Secure app
3. Open STS Secure app
4. Create an STS Secure account
5. Validate your email address

1. Getting Started

Download STS Secure app from Google Play and Create an Account

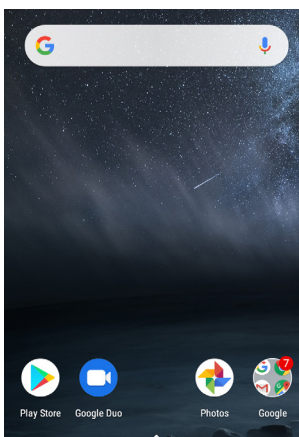

On your Android smartphone, select **Google Play** Store.

NOTE: If Google Play Store isn't on your home page, you will find it in *Applications*.

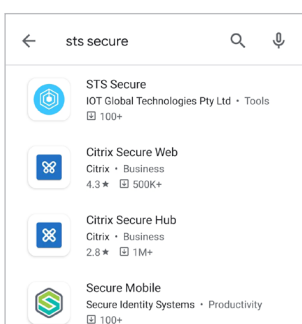

In the App Store search field, begin typing **STS Secure**.

Select **STS Secure** from the predictive search results.

The *STS Secure app* page will open.



This guide is for Android 5+ Smartphone users.



Install STS Secure app

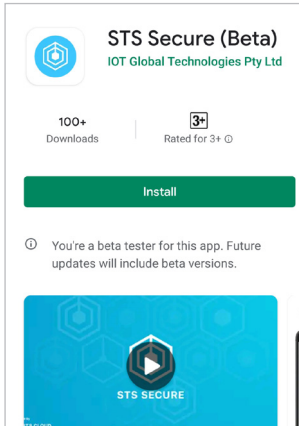

On the *STS Secure app* page, select **Cloud** icon (top right).

The STS Secure app will download.

Open STS Secure app and create an account

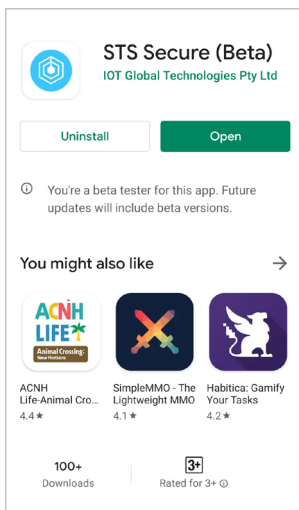

When STS Secure is installed, the **OPEN** button shows.

Select **OPEN** button (top right).

The *Create an STS Secure account* page will open.

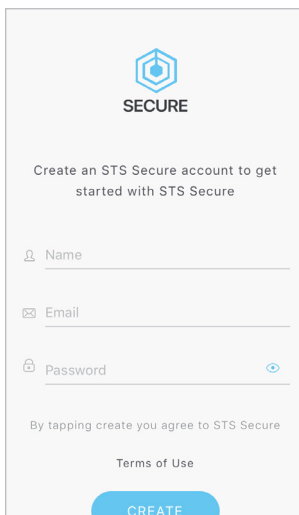

On the *Create an STS Secure account* page, enter:

- your **Name**
- your **Email** address. This will be your Username and it's where your notifications will be sent.
- A 6-digit **Password**.

Select **CREATE** button.

NOTE: When you get a pop-up message to allow notifications, select **Yes** so you will receive notifications from STS Secure.

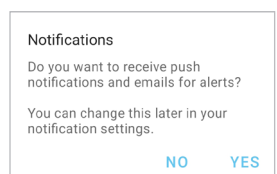

When the pop-up closes, select **CREATE** button again.



This guide is for Android 5+ Smartphone users.



Validate your email address

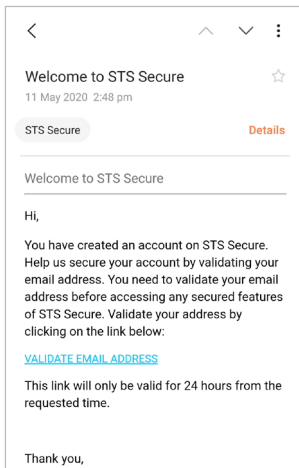

Before STS Secure processes your request and opens your iCloud account it first makes sure it has the right person by sending you a validation email, called: **Welcome to STS Secure**.

Open and read the email, then select the **VALIDATE EMAIL ADDRESS** link.

You will receive a confirmation and your STS Secure iCloud account will be opened.

You can now return to the STS Secure app, where the *Devices* page displays.

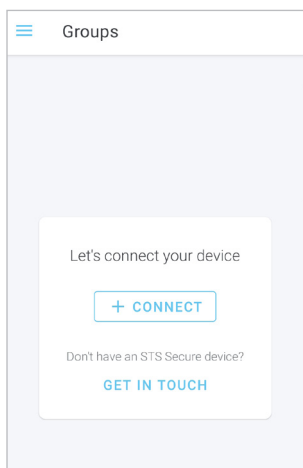

The first screen will prompt you to add a device.

Tap the **+ CONNECT** button

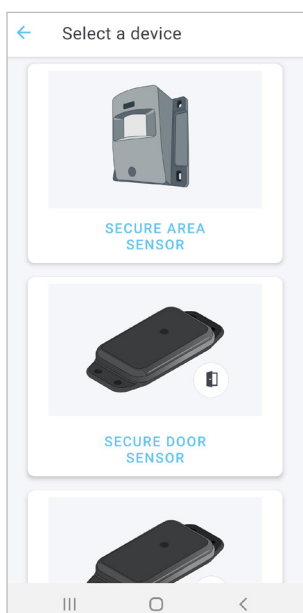

Tap on the **SECURE AREA SENSOR**



This guide is for Android 5+ Smartphone users.



2. Connect your AbiFit Sensor

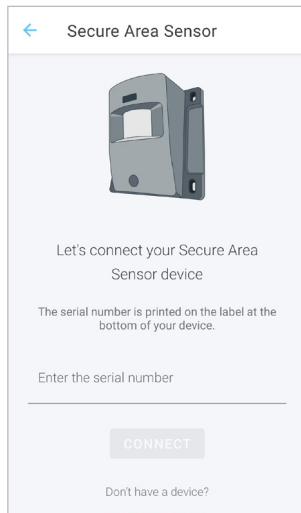

On the *Secure Area Sensor* page you will be prompted to enter the device serial number.

On the *Secure Area Sensor* page, enter the **15 digit serial number** from the barcode inside the battery cover. and select **CONNECT**.

Once connected, the *New Group* page will open.

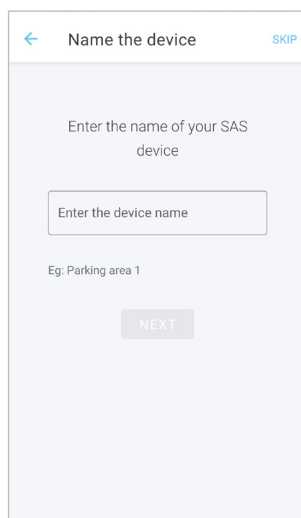
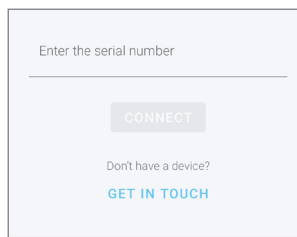

The next screen will prompt you to enter the device name.

Name the device and then select **NEXT**.

Name so it is easily identifiable ie: Jake's bedroom

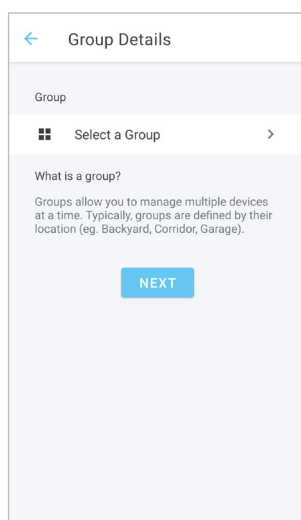

The following screen will prompt you select or create a group.

Groups are used if you are monitoring sensors at different locations. Creating a group is not required for sensors in one location.

Select **NEXT**. If there is no group selected, another window will pop up. Select **OKAY** to create a new group or **CANCEL**.

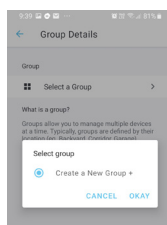



This guide is for Android 5+ Smartphone users.



Name your group (if required) then select **NEXT**

3. Set the Routine

The following screen will prompt you to select a routine.

Select **24** for 24hour monitoring or select **Create a new Routine**

Select **OKAY**, then **NEXT**

Name your routine

Select **DONE**



This guide is for Android 5+ Smartphone users.

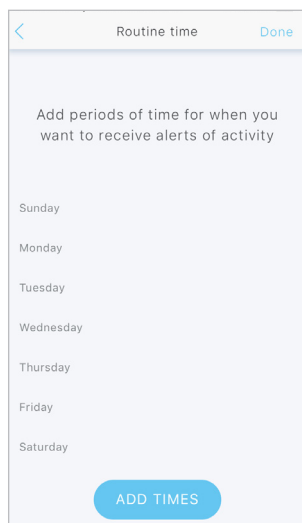

The following screen will prompt you to set up the scheduled routine. To enter the days and times when you would like to be notified for unusual activity, select **ADD TIMES**

IMPORTANT

Your AbiFit sensor monitors for rapid motion 24/7 but the app will only send SMS and/or email notifications when rapid motion **is detected within the scheduled routine periods.**

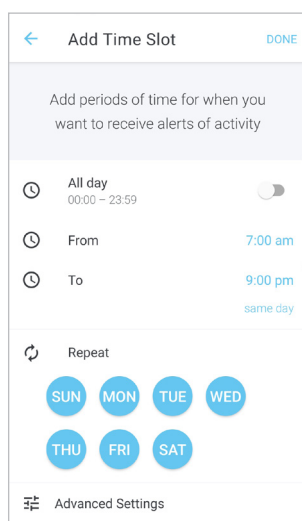

Enter the times when you would like to be notified for unusual activity, then select the required days.

Select **DONE**

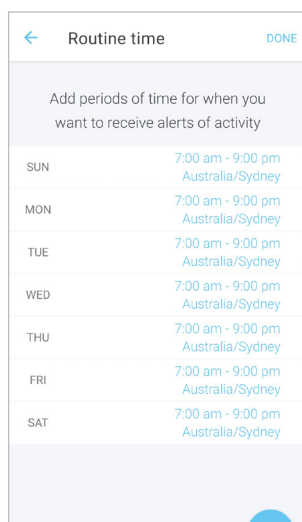

Check the times are set as you would like and adjust if required by tapping on the time. Select **DONE**

The *Routines* page will open.



This guide is for Android 5+ Smartphone users.

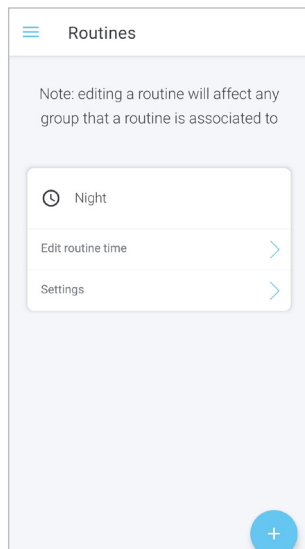

Here you can add additional routines if required by clicking on the +

Changing Locations – Advanced Settings

The location should be set for the city where the AbiFit sensor is placed. If you (the app user) are in a different city, you will need to change locations.

Click on the *Routine* page

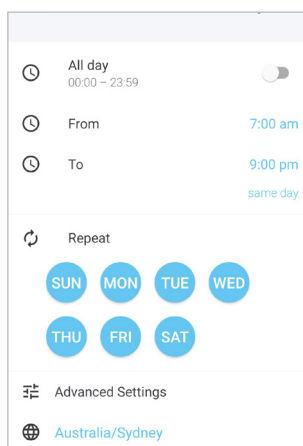

At the bottom of the *Routine* page, click on the location
The *Add Time Slot* page will open.

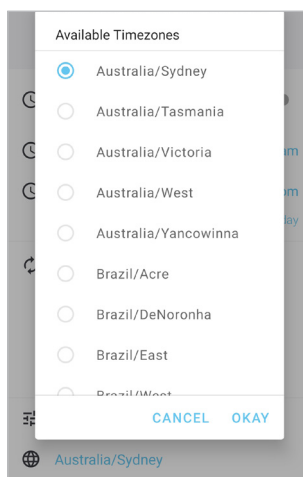

The *Available Timezones* page will open.
Select the new location and press **OKAY**





This guide is for Android 5+ Smartphone users.

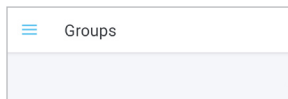

Adding Secondary Carers to your Account

Before starting, ensure the Secondary Carer has download the STS Secure app, created and verified their account.



On the top left-hand corner of the app click on the  icon
The menu will open listing Groups, Routines, Members, Notifications and Logout

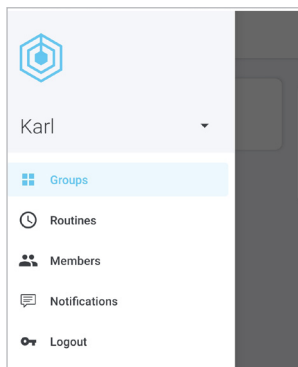

Select **Members** and move to the next screen

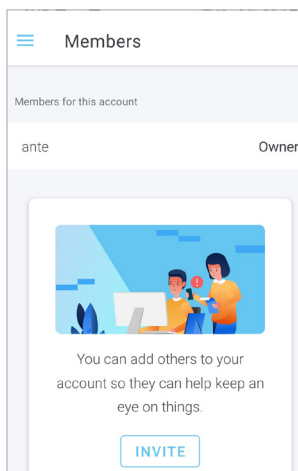

On the next screen select **Invite**, then click on the **+** in the bottom right corner of the screen

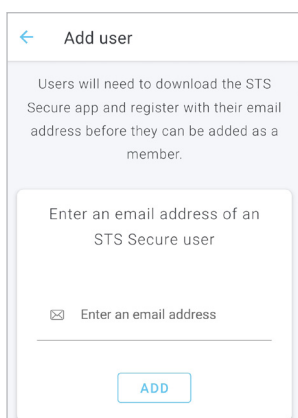

The next screen you will be prompted to enter the email address of the member that you are adding to your account.
Enter the email address and then select **ADD**

When adding another member another window will pop up asking to enter an account name. Enter their name and then select **OKAY**

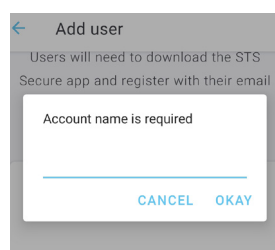



This guide is for Android 5+ Smartphone users.

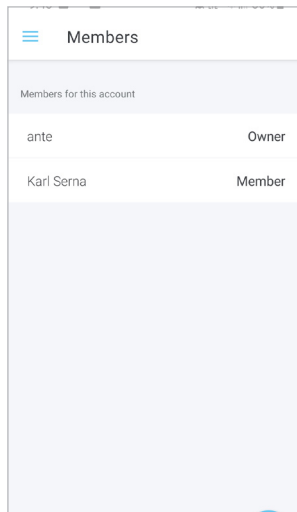

Once done the screen will now display the owner and member.

Note: When the person who has been added logs into the STS app, they will be prompted to add a Sensor. This step is not necessary as they have been added to your active account. They will however, need to switch accounts to view your sensors.

Switching Accounts

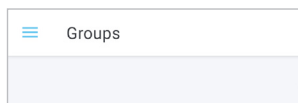

Ask the secondary carer to follow these steps to switch to your account:
Login to their STS Secure app (on their phone)

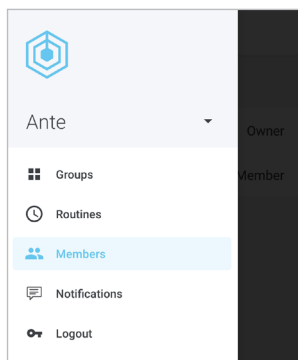

On the *Groups* page, select  icon (top left), the *Menu* page will open

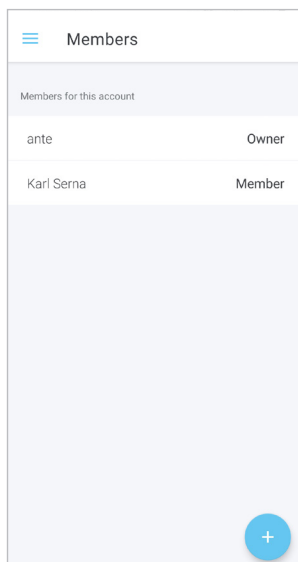

On the *Menu* page, switch to the account they have been added to (your account) and select **OK**

The *Groups* page will open with a brief 'updating status' message. Your secondary carer can now access the AbiBird devices connected to your account.